

WARNING!



Be sure electrical power is OFF before and during installation or maintenance.
The luminaire must be installed by a qualified electrician, in accordance with all applicable local codes.

Ensure that the rated luminaire voltage requirements are compatible with the available mains supply in which it will be installed.
All LEDs are included in your lamp. Never touch the LED surface with your bare hands as this may reduce the life of your LED.
Do not alter, relocate or remove any electrical component.

Line: Oyster
Family: Wall
Description: Accord Oyster Wall Sconce 4208
Material: Natural Wood Vener, MDF and Frosted Glass Globe

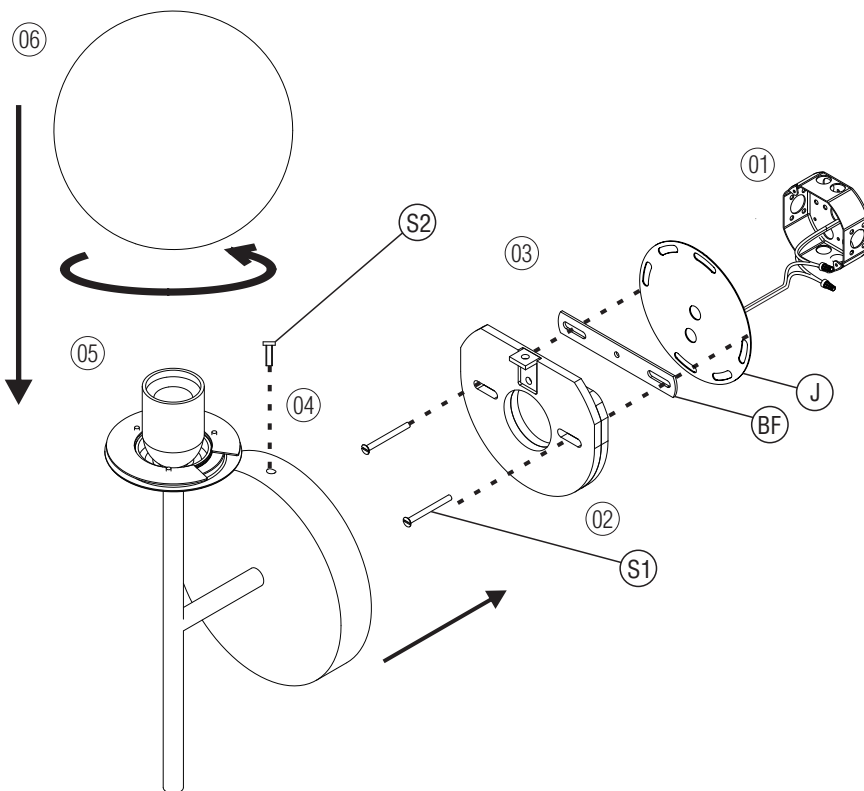

Read carefully all the assembling instructions below and turn OFF energy power before starting the installation.

Turn off the electrical power before starting the installation, and keep it turned off until the installation is completed.

- 01 Make the electrical connections in compliance with all applicable safety standards and electrical installation codes. This product must be installed in accordance with applicable technical standards and by a person familiar with electrical installations, the product, and aware of the associated risks.
- 02 Using the provided screws (S1), secure the mounting bar (BF) and the mounting base (B) to the junction box (J).
- 03 Next, bring the light fixture to the mounting base fixed on the wall, positioning it until the piece fits into place.
- 04 Using the provided screws (S2), secure the fixture to the base by inserting the screws into the top part of the piece. Ensure everything is firm and secure.
- 05 After securing the light fixture to the wall, remove the glass bulb by unscrewing it counterclockwise. Install a compatible LED bulb with an E-27 socket, respecting the limit of up to 25W.
- 06 Then, replace the glass globe by screwing it in clockwise.

Turn on the electrical power.

Your fixture is ready for use

PROVIDED SCREWS

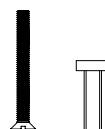

ATTENTION!



FAILURE TO COMPLY WITH THESE INSTRUCTIONS MAY CAUSE ACCIDENTS AND LOSS OF PRODUCT WARRANTY.
It is recommended to read these instructions completely and carefully before proceeding.

SAVE THESE INSTRUCTIONS FOR FUTURE REFERENCE.

ACCORD Lighting guarantees coverage against manufacturing defects including electrical components and finishes, for a period of three years, under normal use, from the date of purchase. For warranty service, please contact your local dealer for further instructions. Proof of date of purchase will be required for validation of warranty service.

The responsibility of the manufacturer regarding the product warranty is related to the correct observation of the instructions contained in this manual.
The manufacturer is not responsible for any damage to the product caused by accidents, alterations of any kind, improper usage or improper installation.
See the website for additional warranty details.

ACCORD Lighting reserves the right to change the dimensions and specifications contained in this manual without prior notice, in accordance with its policy of continuous product improvement. Please, contact the manufacturer if additional information is necessary. The illustrations in this manual are for guidance only and may vary in scale, dimensions and model details.

WARNING!



Be sure electrical power is OFF before and during installation or maintenance.
The luminaire must be installed by a qualified electrician, in accordance with all applicable local codes.

Ensure that the rated luminaire voltage requirements are compatible with the available mains supply in which it will be installed.
All LEDs are included in your lamp. Never touch the LED surface with your bare hands as this may reduce the life of your LED.
Do not alter, relocate or remove any electrical component.

Line: Oyster
Family: Wall
Description: Accord Oyster Wall Sconce 4209
Material: Natural Wood Vanner and MDF

Read carefully all the assembling instructions below and turn OFF energy power before starting the installation.

Turn off the electrical power before starting the installation, and keep it turned off until the installation is completed.

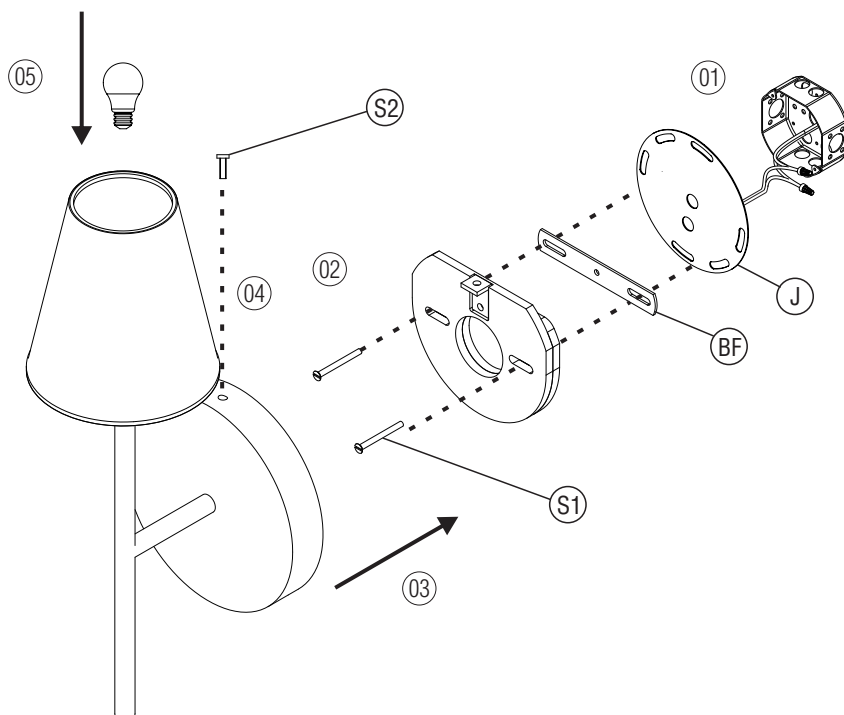

- 01 Make the electrical connections in compliance with all applicable safety standards and electrical installation codes. This product must be installed in accordance with applicable technical standards and by a person familiar with electrical installations, the product, and aware of the associated risks.
- 02 Using the provided screws (S1), secure the mounting bar (BF) and the mounting base (B) to the junction box (J).
- 03 Next, bring the light fixture to the mounting base fixed on the wall, positioning it until the piece fits into place.
- 04 Using the provided screws (S2), secure the fixture to the base by inserting the screws into the top part of the piece. Ensure everything is firm and secure.
- 05 After securing the light fixture to the wall, install a compatible LED bulb with an E-27 socket, respecting the limit of up to 25W.

Turn on the electrical power.

Your fixture is ready for use

ATTENTION!



FAILURE TO COMPLY WITH THESE INSTRUCTIONS MAY CAUSE ACCIDENTS AND LOSS OF PRODUCT WARRANTY.
It's recommended to read these instructions completely and carefully before proceeding.

PROVIDED SCREWS

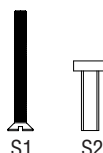

SAVE THESE INSTRUCTIONS FOR FUTURE REFERENCE.

ACCORD Lighting guarantees coverage against manufacturing defects including electrical components and finishes, for a period of three years, under normal use, from the date of purchase. For warranty service, please contact your local dealer for further instructions. Proof of date of purchase will be required for validation of warranty service.

The responsibility of the manufacturer regarding the product warranty is related to the correct observation of the instructions contained in this manual.
The manufacturer is not responsible for any damage to the product caused by accidents, alterations of any kind, improper usage or improper installation.
See the website for additional warranty details.

ACCORD Lighting reserves the right to change the dimensions and specifications contained in this manual without prior notice, in accordance with its policy of continuous product improvement. Please, contact the manufacturer if additional information is necessary. The illustrations in this manual are for guidance only and may vary in scale, dimensions and model details.